

1172



CLONTARF CASTLE  
DUBLIN

#sharethestory

Castle Avenue,  
Clontarf, Dublin 3,  
Ireland, D03 W5N0

conbq@clontarfcastle.ie

www.clontarfcastle.ie

+353 (0)1 833 2321



### HOTEL FACILITIES

- 4\* hotel, in a 12th century castle setting
- 111 guest bedrooms & suites
- AA Rosette winning restaurant
- 2 bars
- Fitness Suite
- 10 minutes from Dublin City Centre
- 20 minutes from Dublin Airport



### CONFERENCE & EVENTS

- Rooms & Features:
- 442m2 Great Hall
  - 192m2 Viking Suite
  - 8 meeting rooms
  - Air-conditioning & natural daylight in all conference & event rooms



### TECHNOLOGY

- High-speed WiFi
- Display screens for logos
- Three 415 Volt 3-phase supplies 125 amp, 63 amp & 40 amp
- Drop down screens in all meeting rooms
- Data projectors
- Built in PA systems





Name	Location	Length	Width	Ceiling	Classroom	Theatre	U Shaped	Banquet	B/room
Great Hall	Ground Floor	27.74 m	15.93m	4.5m	250	600	90	330	-
Great Hall 1	Ground Floor	14.6m	16.5m	4.5m	120	250	45	150	45
Great Hall 2	Ground Floor	19.8m	9.7m	2.4m	120	250	45	150	45
Viking Suite	Lower Ground Floor	19.8m	9.7m	2.4m	65	150	45	140	-
Viking Room 1	Lower Ground Floor	7.62 m	7.87m	2.4m	25	50	25	30	25
Viking Room 2	Lower Ground Floor	6.77m	10.52m	2.4m	25	50	28	30	28
Viking Room 3	Lower Ground Floor	5.64m	8.82m	2.4m	15	30	15	30	15
Norman Suite	Lower Ground Floor	7.34m	7.87m	2.4m	25	50	25	30	25
Dalcassian Suite	Lower Ground Floor	9.45m	6.45m	2.4m	25	50	25	-	25
Tower Suite	Upstairs Tower	5m	4.80m	2.4m	10	20	12	24	-



## CLONTARF CASTLE EVENTS, CONFERENCE & MEETING FLOOR PLANS

### GROUND FLOOR

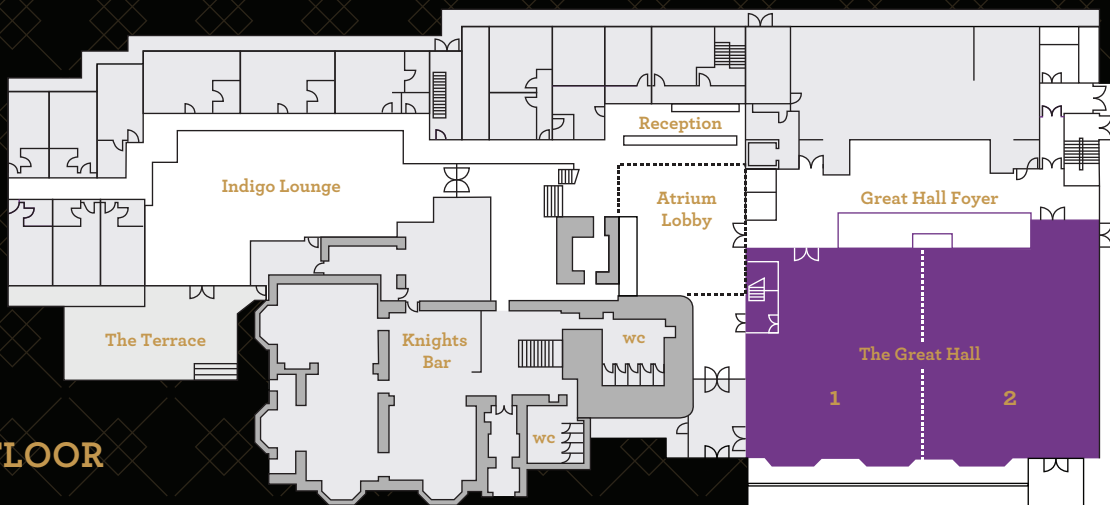

### LOWER GROUND FLOOR

